

HongKongLens

No. 4



Dear HWE Leaders,

Choice greetings from Hong Kong in the wonderful name of our Lord & Saviour Jesus Christ!

Having been in Hope for some 18 years, I can see clearly that the key strategy to quantitative church growth is Student Ministry. I can also see this in the UK. We have 4 churches, London Central, London West, Leeds and Hatfield. Hatfield, despite being the youngest, is growing faster than the other 3. The reason is principally 2 fold:

- 1) It has a 90+% student congregation
- 2) The pastor is also a student

The time and focus the congregation have really enhance church growth, because the majority of them do not have full time jobs and family commitments.

But, how can we help churches like Leeds and London West where members are principally working full time with young families. Also London Central, which has a small student population.

Having been back to full-time work in the past 3+ months, I can understand very well the demand on the workers' time and energy in the work place. I must say our church working people are exceptional, esp. our leaders. I take my hat off to those who are working full-time and serving God fully as well.

Whilst it is my plan to reduce my working hours in the work place going forward, when my current contract finishes, the majority, if not all of our working people will still be working full-time until much later in their lives, unless they are pastors already. In which case, they should progressively look to the church to support them going part-time or full-time.

The fact is, working people (esp. professionals) are essential to the long term growth of our churches. They provide the finance that the church depends on. They also give credibility to the church and attract busy professionals and senior professionals to join the church. All mega churches have a good percentage of senior professionals and business men/women in their congregations.

But I believe that this group of people can be a lot more effective in advancing the Kingdom of God than they are now. They may not realize it at present.

I want to share with them a few keys based on my own experience:

1) Have a Kingdom Mentality (putting God and His agenda first)

My favourite Scripture is **[Matt. 6:33]** "...seek first his kingdom and his righteousness, and all these things will be given to you as well."

If one has the desire to centre one's life plan around advancing God's kingdom, God will also honour and bless the work of the person's hand. Senior professionals and business owners can have successful careers & businesses, and play major roles in advancing the Kingdom of God. The key is to have a Kingdom Mentality.

2) Have a Disciplined Prayerful Life

Having been a church leader for over 15 years, 12 of them as a pastor, I come to know the truth in **[John 15:5]** "I am the vine; you are the branches. If a man remains in me and I in him, he will bear much fruit; apart from me you can do nothing."

Indeed, apart from God I cannot live a victorious life, be it building God's church or simply living each day as a professing Christian.

I get up at 5:15 each morning. Talk to Kim on the phone for about 10 min and go for a 20min prayer jog, praying for my family, the church, the leaders, my project, my colleagues (including those who are giving me a difficult time), my contacts and my future ministry in HK & China. After a nice shower and a good breakfast, I will be arriving in the office at 8:00. I then do a prayer walk around the office, sit down to read my Bible and start my day's work. I put in some 10 hours a day without feeling tired. Each night, I go to bed around 10:30 and I thank God for each day as I rest my head on the pillow.

3) Treat work as a ministry

i) Pray for people in the workplace

[1 John 5:19] ".....the whole world is under the control of the evil one.'

[Eph 6:12] "For our struggle is not against flesh and blood, but against the rulers, against the authorities, against the powers of this dark world and against the spiritual forces of evil in the heavenly realms."

The above 2 scriptures tell us that the workplace is under the control of the evil one and our struggle is against the power of darkness. We can only overcome with the power of God through prayer.

ii) Be a good example

[Matt 5:16] "In the same way, let your light shine before men, that they may see your good deeds and praise your Father in heaven."

Our good example can really draw people to God. I will share more on this point in my next newsletter.

A Testimony

When God opened a door for me to come back to Hong Kong in February, I knew its not going to be easy because the job is a demanding one. I am the Project Manager responsible for the

successful delivery of the design of a very complex project – the iconic Entrance Building of the Main Terminus of the High Speed Rail Link to China in West Kowloon.

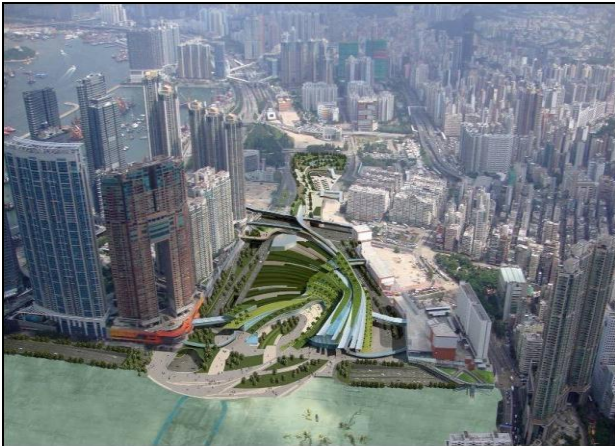

Location of the Terminus



Overview of Terminus with Above Station Property Development

I have shared a bit about the challenges I was facing on Day 1:

- 1) The project had been going for 9 months ago and I had to get up to speed in the shortest possible time
- 2) The project is very challenging technically because the Architect has adopted an architectural form that is very difficult to design.
- 3) I had to manage a no. of consultant firms who are not very responsive and co-operative.
- 4) I had to work 10 hr. a day, 5 days a week.



Interior of Entrance Building (1)

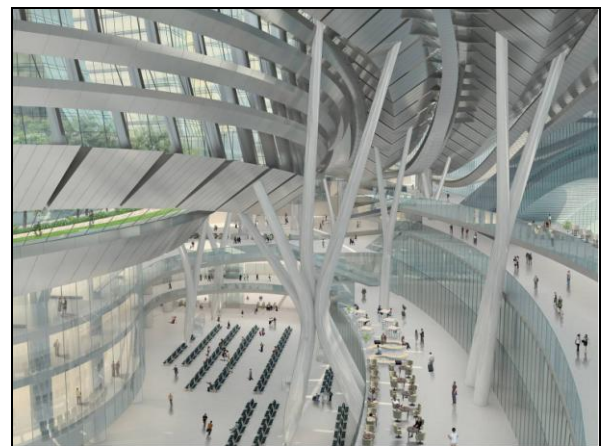

Interior of Entrance Building (2)

Despite of these difficulties, when I applied the above principles, I could see God's favour in helping me to do a good job.

Also, more recently, God impressed upon my heart that "the battle belongs to Him". Instead of using my own understanding and human wisdom to deal with issues, God asked me to humble myself and depend on Him.

In the past month I was under a lot of criticism by the Architectural Discipline Leader (ADL) for not managing the Landscape Designers well. The truth was that their company were trying to expand into the landscape business. I was between a rock and a hard place because the Landscape Designers are from our company and they have been performing below par.

One day God came to my aid. The Landscape Designers presented the design of the Civic Plaza - a key landscape feature of the Terminus Building to the Client. The Client was very pleased with the design. The Architect Discipline Leader's boss was also present. I quietly thank God for the good result.



Civic Plaza (View 1)



Civic Plaza (View 2)

Then something amazing followed. After the presentation, a junior architect gave me a drawing of the Civic Plaza and told me that the Architect team have forgotten to allow for 7 parking spaces required by the Fire Services Department in case of a fire. This requirement would mess up the Civic Plaza design just presented to the Client. I showed that drawing to the ADL's boss and he was furious.

God used this incidence to teach the ADL a lesson. The ADL was humbled and became less critical. The battle truly belong to God; apart from Him we can do nothing!

Concluding Remarks

I want to encourage fellow professionals and working people in the church to treat the market place as a ministry. We will see God's Kingdom advancing in all arenas, not just in the church or home groups, but wherever God places us in our daily life. Amen!

With love & prayers in Christ,

Handwritten signature of PK Tse.

PK Tse
Hong Kong
16th June, 2010